

2181193-1 ✓ ACTIVE

## NECTOR

TE Internal #: 2181193-1

Lighting Cable Assemblies, NECTOR S LINE 2POS FEMALE,  
Length .61 m [1.668 ft], 24VDC Voltage Rating, Mini HVL Plug, HV-3,  
2 Position, White Housing

[View on TE.com >](#)



Cable Assemblies > Copper Cable Assemblies > Lighting Cable Assemblies

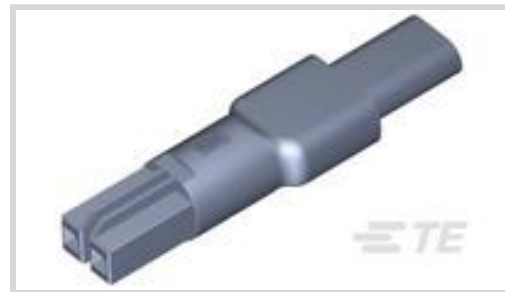

Product Line: **NECTOR S LINE 2POS FEMALE**

Wire Color (Base): **White**

Cable Assembly Length: **.61 m [ 1.668 ft ]**

Voltage Rating: **24 VDC**

Connector Type (End A): **Mini HVL Plug**

### Features

#### Product Type Features

|                        |                               |
|------------------------|-------------------------------|
| Wire/Cable Type        | Discrete Wire                 |
| Cable Assembly System  | Wire-to-Wire                  |
| Product Type           | Cable Assembly                |
| Glow Wire Rating       | Standard Part - Not Glow Wire |
| Product Line           | NECTOR S LINE 2POS FEMALE     |
| Connector Type (End A) | Mini HVL Plug                 |
| Cable Assembly Type    | Mini HVL Pigtail              |

#### Configuration Features

|                     |      |
|---------------------|------|
| Number of Rows      | 1    |
| Keyed               | Yes  |
| Keying Arrangement  | HV-3 |
| Number of Positions | 2    |

#### Electrical Characteristics

|                |        |
|----------------|--------|
| Voltage Rating | 24 VDC |
|----------------|--------|

#### Body Features

|                   |       |
|-------------------|-------|
| Wire Color (Base) | White |
|-------------------|-------|

#### Contact Features

|              |        |
|--------------|--------|
| Contact Type | Socket |
|--------------|--------|



|                        |        |
|------------------------|--------|
| Accepts Contact Gender | Socket |
|------------------------|--------|

### Termination Features

|                                    |       |
|------------------------------------|-------|
| Termination Method to Wire & Cable | Crimp |
|------------------------------------|-------|

### Mechanical Attachment

|                       |       |
|-----------------------|-------|
| Mating Alignment Type | Keyed |
|-----------------------|-------|

|                  |      |
|------------------|------|
| Mating Retention | With |
|------------------|------|

|                       |         |
|-----------------------|---------|
| Mating Retention Type | Locking |
|-----------------------|---------|

|                  |      |
|------------------|------|
| Mating Alignment | With |
|------------------|------|

### Housing Features

|               |       |
|---------------|-------|
| Housing Color | White |
|---------------|-------|

### Dimensions

|           |        |
|-----------|--------|
| Wire Size | 18 AWG |
|-----------|--------|

### Usage Conditions

|                             |                            |
|-----------------------------|----------------------------|
| Operating Temperature Range | -40 – 110 °C[-40 – 230 °F] |
|-----------------------------|----------------------------|

### Industry Standards

|                 |    |
|-----------------|----|
| Agency/Standard | UL |
|-----------------|----|

|                        |          |
|------------------------|----------|
| UL Flammability Rating | UL 94V-0 |
|------------------------|----------|

### Other

|                       |                 |
|-----------------------|-----------------|
| Cable Assembly Length | .61 m[1.668 ft] |
|-----------------------|-----------------|

## Product Compliance

[For compliance documentation, visit the product page on TE.com>](#)

|                              |           |
|------------------------------|-----------|
| EU RoHS Directive 2011/65/EU | Compliant |
|------------------------------|-----------|

|                             |           |
|-----------------------------|-----------|
| EU ELV Directive 2000/53/EC | Compliant |
|-----------------------------|-----------|

|   |   |
|---|---|
| China RoHS 2 Directive MIIT Order No 32, 2016 | No Restricted Materials Above Threshold |
|---|---|

|  |  |
|--|--|
| EU REACH Regulation (EC) No. 1907/2006 | Current ECHA Candidate List: JUNE 2022 (224)<br>Candidate List Declared Against: JUN 2016 (169)<br>SVHC > Threshold:<br>Not Yet Reviewed |
|--|--|

|                 |  |
|-----------------|--|
| Halogen Content | Not Low Halogen - contains Br or Cl > 900 ppm. |
|-----------------|--|

|                           |  |
|---------------------------|--|
| Solder Process Capability | Not applicable for solder process capability |
|---------------------------|--|

#### Product Compliance Disclaimer

This information is provided based on reasonable inquiry of our suppliers and represents our current actual knowledge based on the information they provided. This information is subject to change. The part numbers that TE has identified as EU RoHS compliant have a maximum concentration of 0.1% by weight in homogenous materials for lead, hexavalent chromium, mercury, PBB, PBDE, DBP, BBP, DEHP, DIBP, and 0.01% for cadmium, or qualify for an exemption to these limits as defined in the Annexes of Directive 2011/65/EU (RoHS2). Finished electrical and electronic equipment products will be CE marked as required by Directive 2011/65/EU. Components may not be CE marked. Additionally, the part numbers that TE has identified as EU ELV compliant have a maximum concentration of 0.1% by weight in homogenous materials for lead, hexavalent chromium, and mercury, and 0.01% for cadmium, or qualify for an exemption to these limits as defined in the Annexes of Directive 2000/53/EC (ELV). Regarding the REACH Regulations, TE's information on SVHC in articles for this part number is still based on the European Chemical Agency (ECHA) 'Guidance on requirements for substances in articles' (Version: 2, April 2011), applying the 0.1% weight on weight concentration threshold at the finished product level. TE is aware of the European Court of Justice ruling of September 10th, 2015 also known as O5A (Once An Article Always An Article) stating that, in case of 'complex object', the threshold for a SVHC must be applied to both the product as a whole and simultaneously to each of the articles forming part of its composition. TE has evaluated this ruling based on the new ECHA "Guidance on requirements for substances in articles" (June 2017, version 4.0) and will be updating its statements accordingly.

## Compatible Parts



## Documents

### CAD Files

#### Customer View Model

[ENG\\_CVM\\_CVM\\_2181193-1\\_C.2d\\_dxf.zip](#)

English

### 3D PDF

3D

#### Customer View Model

[ENG\\_CVM\\_CVM\\_2181193-1\\_C.3d\\_igs.zip](#)

English

#### Customer View Model

[ENG\\_CVM\\_CVM\\_2181193-1\\_C.3d\\_stp.zip](#)

English

By downloading the CAD file I accept and agree to the [Terms and Conditions](#) of use.

### Product Specifications

#### Product Specification

English